

USE THESE INSTRUCTIONS IN CONJUNCTION WITH  
INSTALLATION INSTRUCTIONS 182970

**CORNER UNIT ASSEMBLY**

CLEAN VERTICAL MEMBER AND ENDS OF  
HORIZONTAL MEMBERS ACCORDING TO SEALANT  
MANUFACTURERS RECOMMENDATION.

APPLY SEALANT TO END OF HORIZONTAL  
MEMBERS AS SHOWN AND ASSEMBLE  
VERTICAL TO HORIZONTAL MEMBERS  
USING 128510 #12 x 1-1/2" HEX WASHER HEAD  
TYPE AB.

TOOL EXCESS SEALANT AFTER ASSEMBLY.

UNIT IS SHOWN IN THE UPRIGHT POSITION, BUT  
MAY BE ASSEMBLED IN ANY DESIRABLE POSITION.

INSIDE GLAZED APPLICATION SHOWN  
OUTSIDE GLAZED APPLICATION SIMILAR

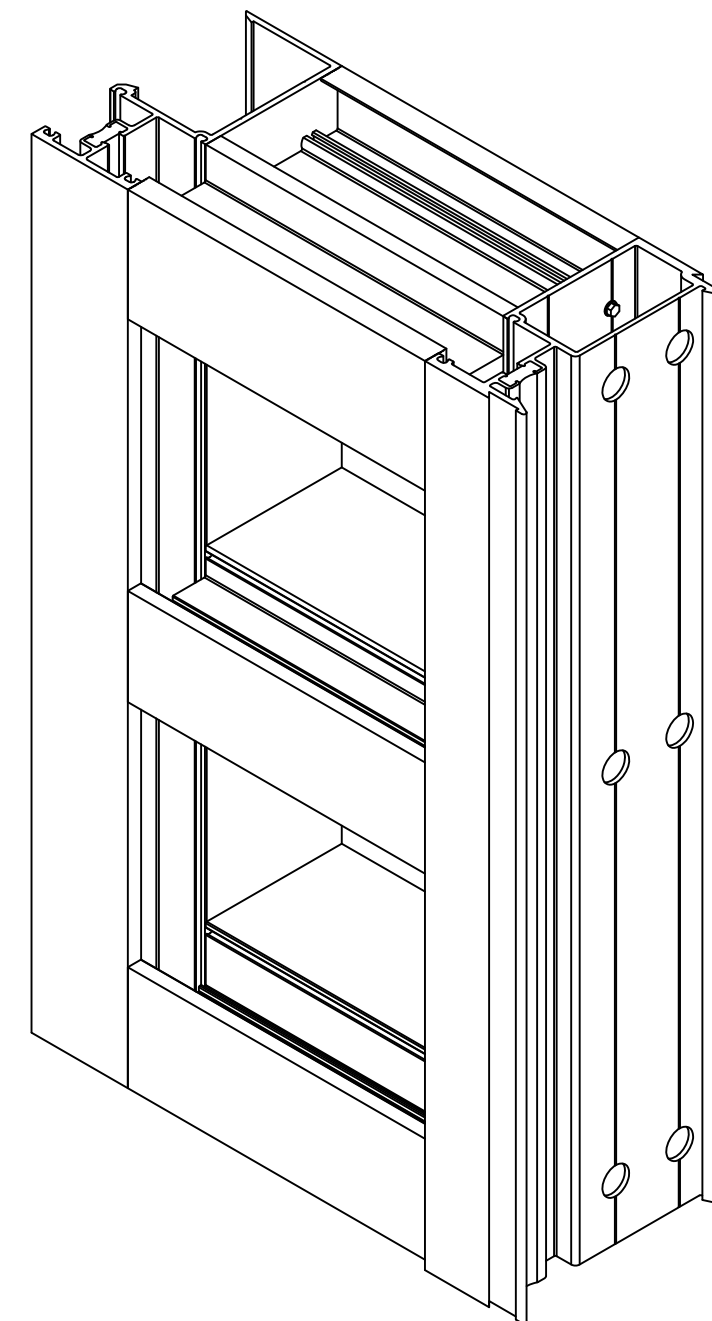
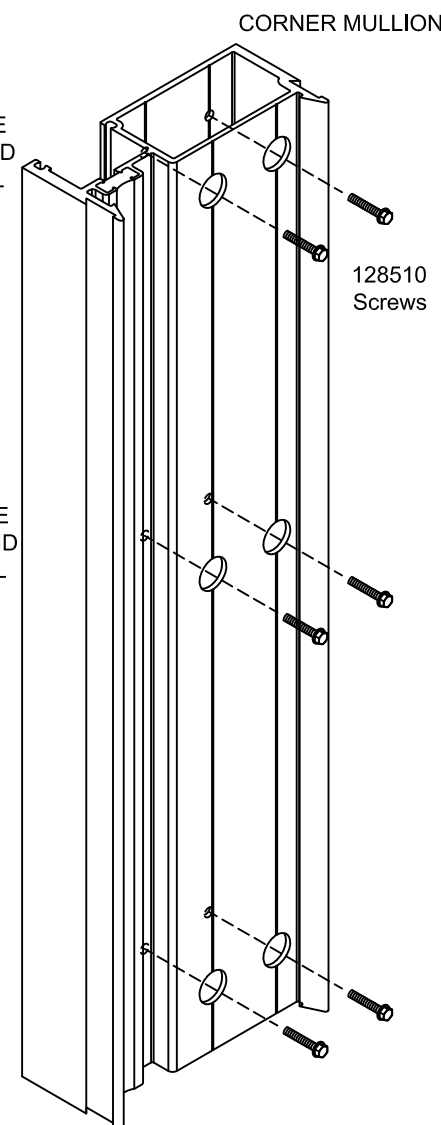
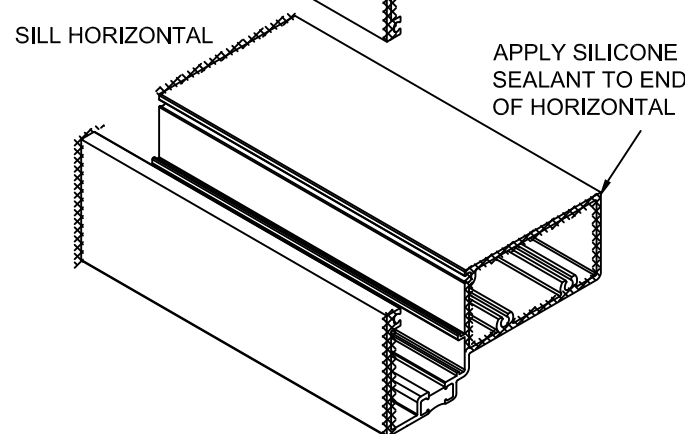
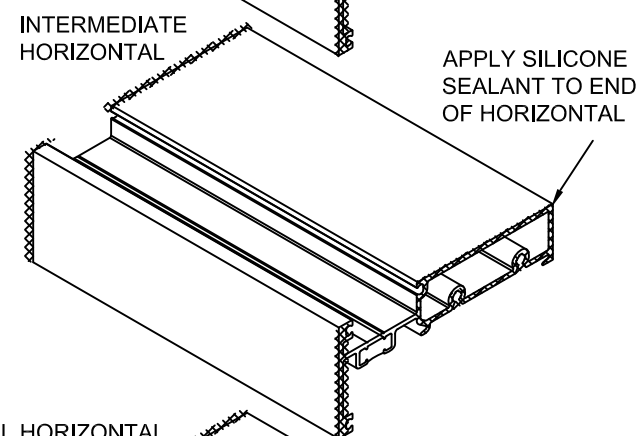
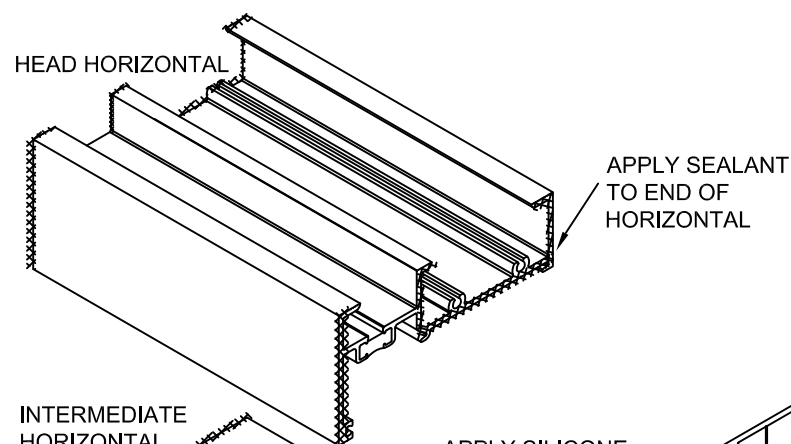
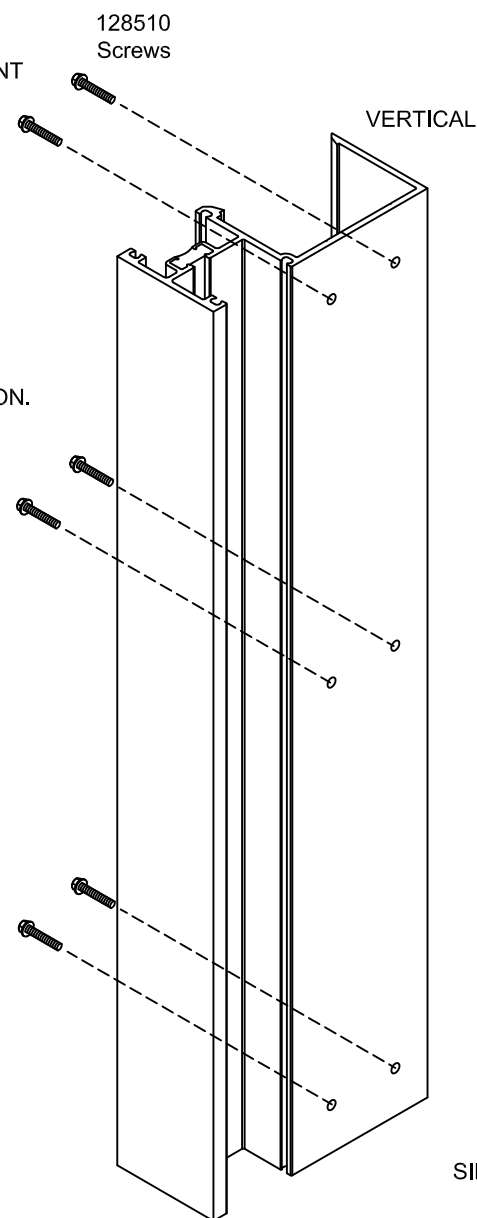

FG 501T CORNER  
INSTALLATION  
INSTRUCTIONS

Product Engineering & Development

95527-004  
12/26/14

182972 SHEET 01 OF 04

## INSTALL CORNER SILL RECEPTOR

MITER ENDS OF SILL RECEPTORS AT CORNER TO CORRECT ANGLE PER APPROVED SHOP DRAWINGS.

ATTACH CORNER CLIP TO SILL RECEPTOR USING 128910 #10-16 x 1/2" FHTF "B" SCREWS AS SHOWN. APPLY SEALANT TO END OF THE SILL RECEPTOR AT CORNER LOCATION PRIOR TO JOINING SILL RECEPTORS.

SLIDE THE SECOND MITERED SILL RECEPTOR ONTO THE CORNER CLIP MAKING SURE THE TWO SILL RECEPTORS ARE TIGHTLY JOINED TOGETHER.

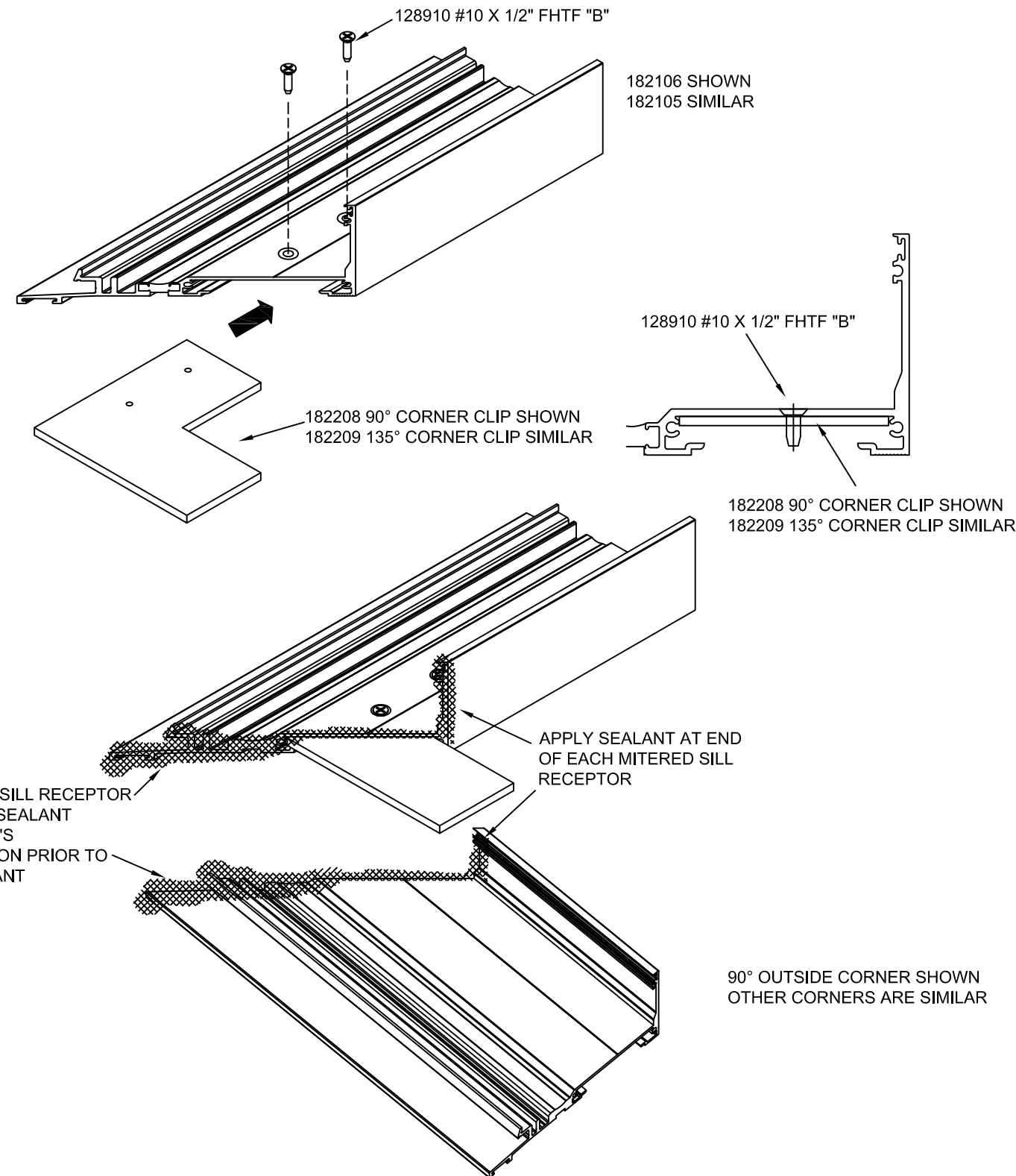

## INSTALL CORNER SILL RECEPTOR

DRILL Ø0.173 (#17 DRILL) AND COUNTERSINK Ø0.385 INTO CORNER CLIP AND SILL RECEPTOR, AS SHOWN. FASTEN CORNER CLIP TO SILL RECEPTOR USING 128910 #10 x 1/2" FHTF "B" SCREWS

APPLY SEALANT TO SCREW HEADS AND CORNER JOINT. TOOL EXCESS SEALANT.

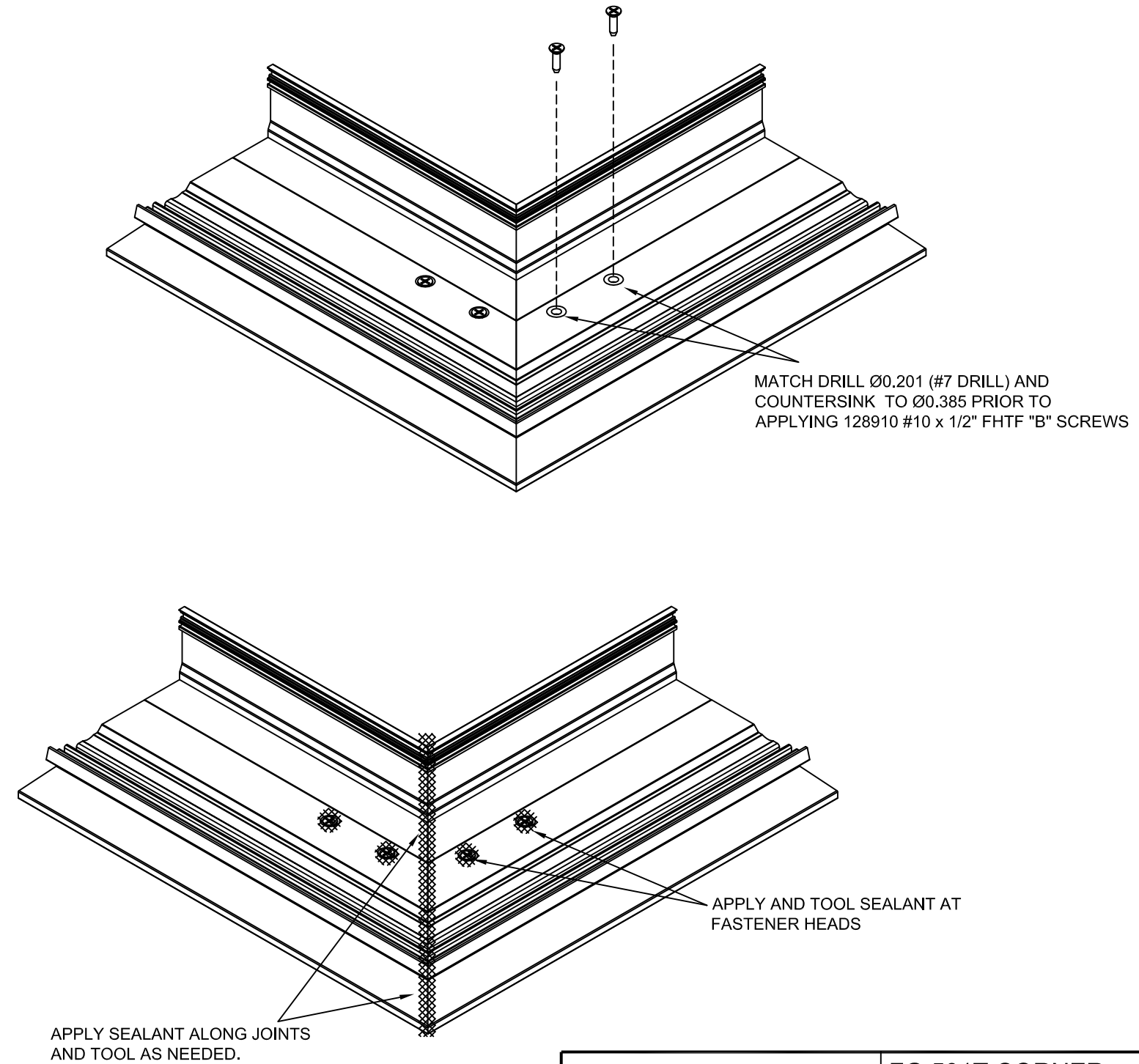

CONFIDENTIAL AND PROPRIETARY INFORMATION  
KAWNEER COMPANY INC.

THESE DRAWINGS ARE THE SOLE AND EXCLUSIVE PROPERTY OF KAWNEER AND CONTAIN SENSITIVE, PRIVILEGED OR CONFIDENTIAL INFORMATION WHICH MAY BE USED ONLY FOR ITS BENEFIT. THE DISCLOSURE OF THESE DRAWINGS TO UNAUTHORIZED PERSONS IS STRICTLY PROHIBITED. THIS DOCUMENT AND ALL COPIES MUST BE RETURNED UPON DEMAND.  
© COPYRIGHT KAWNEER COMPANY, INC., 2014

### INSTALL CORNER HEAD RECEPTOR

MITER ENDS OF HEAD RECEPTORS AT CORNER PER APPROVED SHOP DRAWINGS

ATTACH CORNER CLIP TO HEAD RECEPTOR USING 128344 #10 x 5/16" PHTF SCREWS AS SHOWN. CLEAN ENDS OF HEAD RECEPTORS ACCORDING TO SEALANT MANUFACTURER'S RECOMMENDATIONS PRIOR TO APPLYING SEALANT. APPLY SEALANT TO END OF THE HEAD RECEPTOR AND SLIDE THE SECOND MITERED HEAD RECEPTOR ONTO THE CORNER CLIP MAKING SURE THE TWO HEAD RECEPTORS ARE TIGHTLY JOINED TOGETHER.

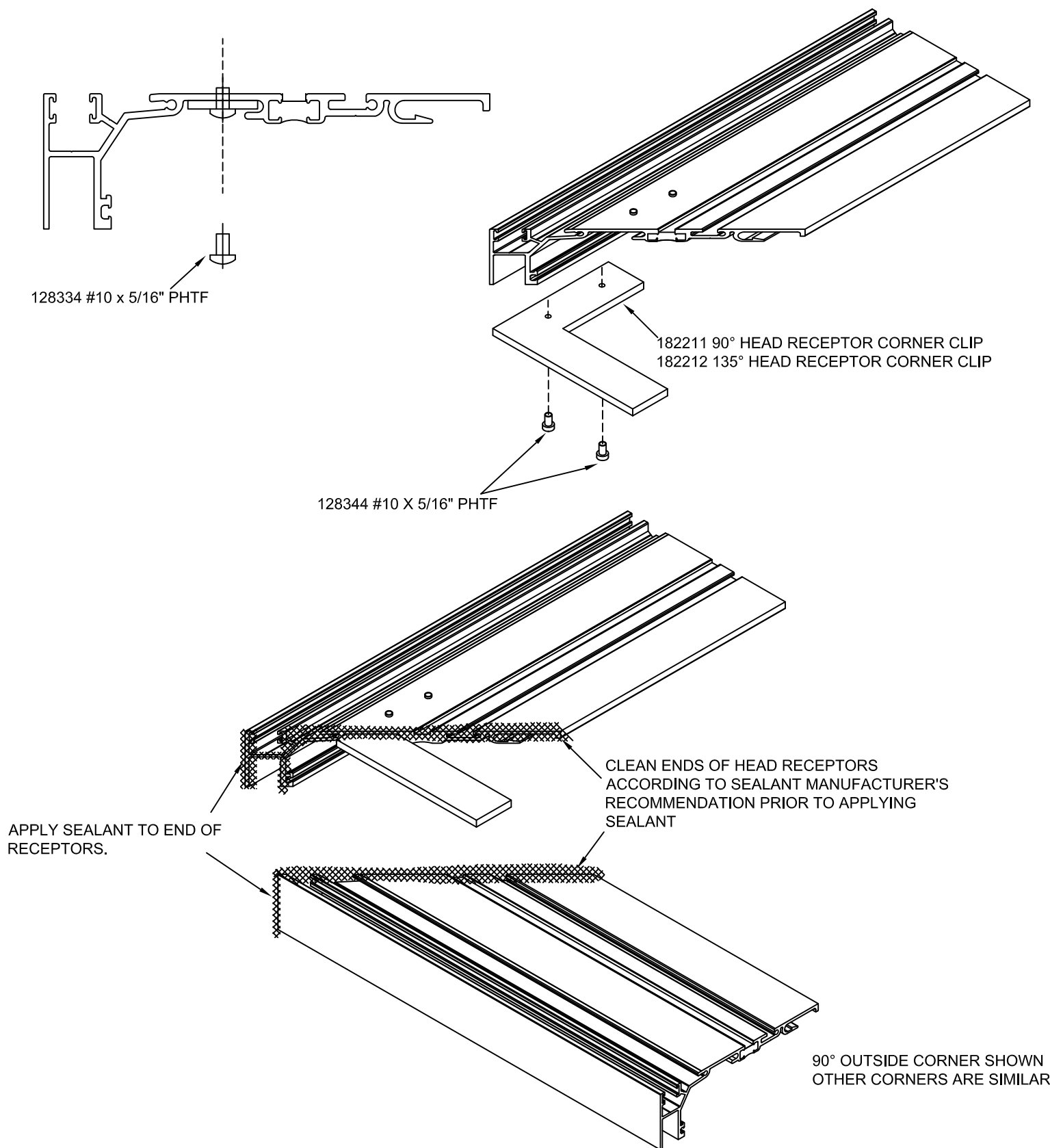

### INSTALL CORNER HEAD RECEPTOR

DRILL Ø0.228 (#1 DRILL) THROUGH CORNER CLIP AND HEAD RECEPTOR, AS SHOWN. FASTEN CORNER CLIP TO HEAD RECEPTOR USING 128293 #12 x 5/8" PHTF "AB" SCREWS

APPLY SEALANT TO SCREW HEADS AND CORNER JOINT. TOOL EXCESS SEALANT.

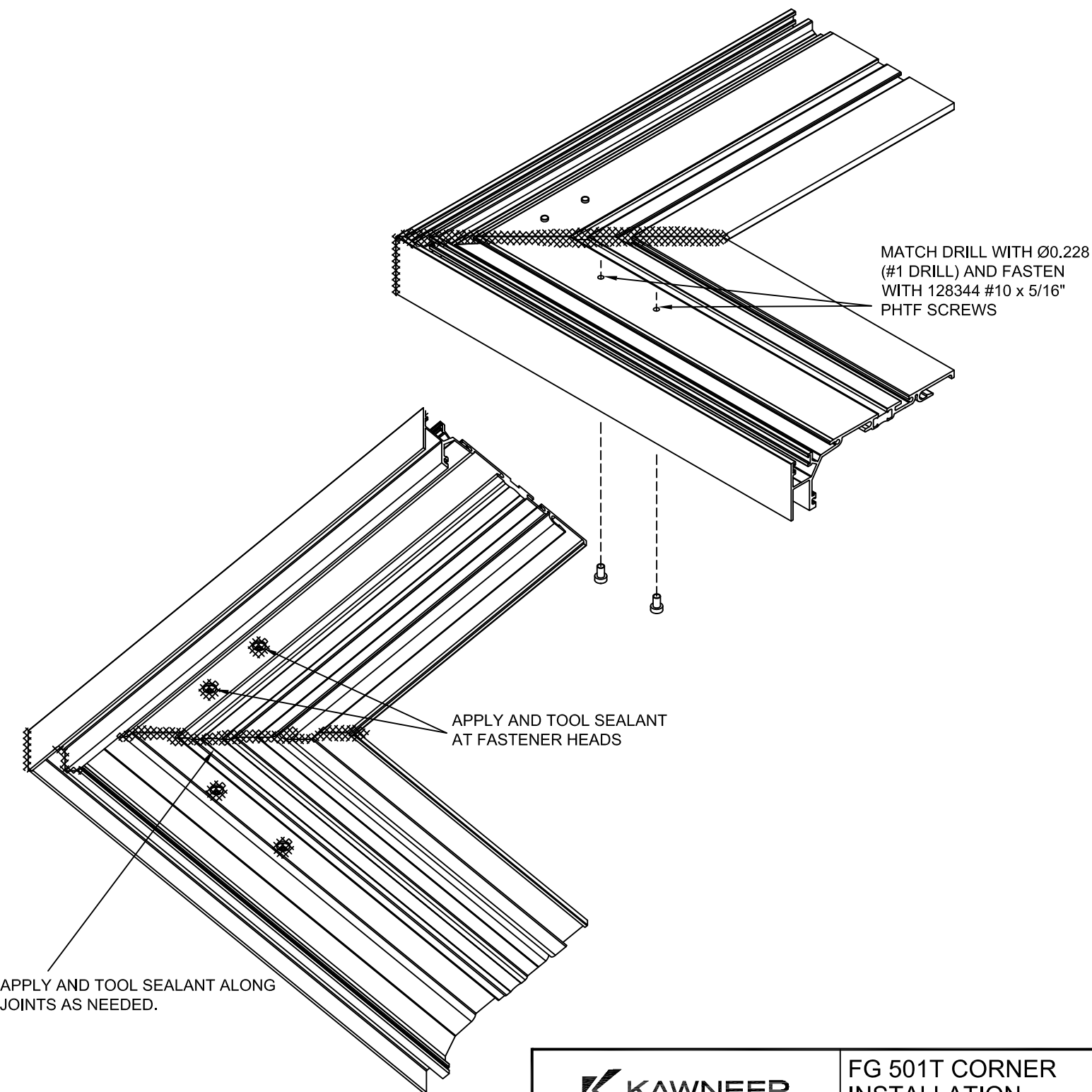

FG 501T CORNER  
INSTALLATION  
INSTRUCTIONS

Product Engineering & Development

95527-004  
12/26/14

182972 SHEET 03 OF 04

CONFIDENTIAL AND PROPRIETARY INFORMATION  
KAWNEER COMPANY INC.

THESE DRAWINGS ARE THE SOLE AND EXCLUSIVE PROPERTY OF KAWNEER AND CONTAIN SENSITIVE, PRIVILEGED OR CONFIDENTIAL INFORMATION WHICH MAY BE USED ONLY FOR ITS BENEFIT. THE DISCLOSURE OF THESE DRAWINGS TO UNAUTHORIZED PERSONS IS STRICTLY PROHIBITED. THIS DOCUMENT AND ALL COPIES MUST BE RETURNED UPON DEMAND.  
© COPYRIGHT KAWNEER COMPANY, INC., 2014

### INSTALL CORNER UNITS

INSTALL ASSEMBLED FRAMES ACCORDING TO APPROVED SHOP DRAWINGS.

#### INSTALL FIRST CORNER UNIT

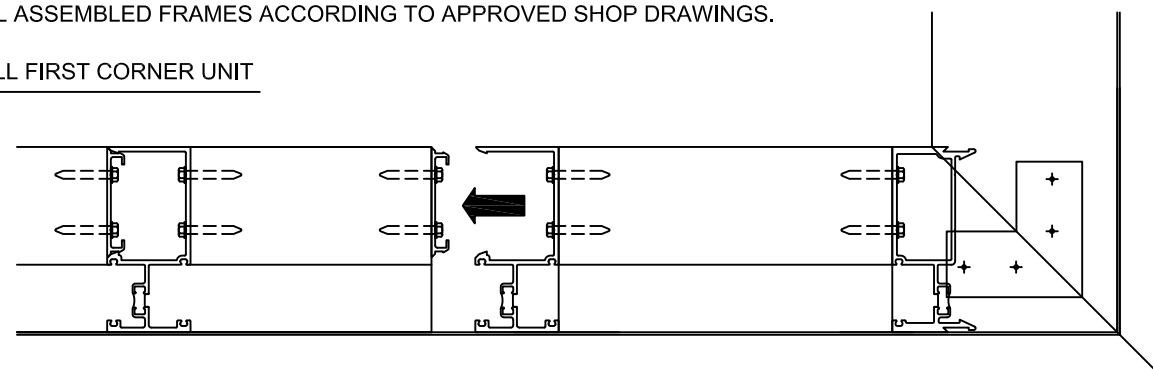

APPLY SEALANT 6" FROM END OF EXPANSION MULLION AT SILL, AS SHOWN BEFORE SNAP IN CORNER CLIPS TO THE EXPANSION MULLION. TOOL EXCESS AND CLEAN OFF SEALANT AT VISION AREA.

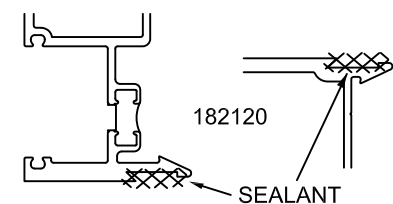

#### INSTALL CORNER CLIPS

182021 90° CORNER CLIP SHOWN  
182024 135° CORNER CLIP SIMILAR

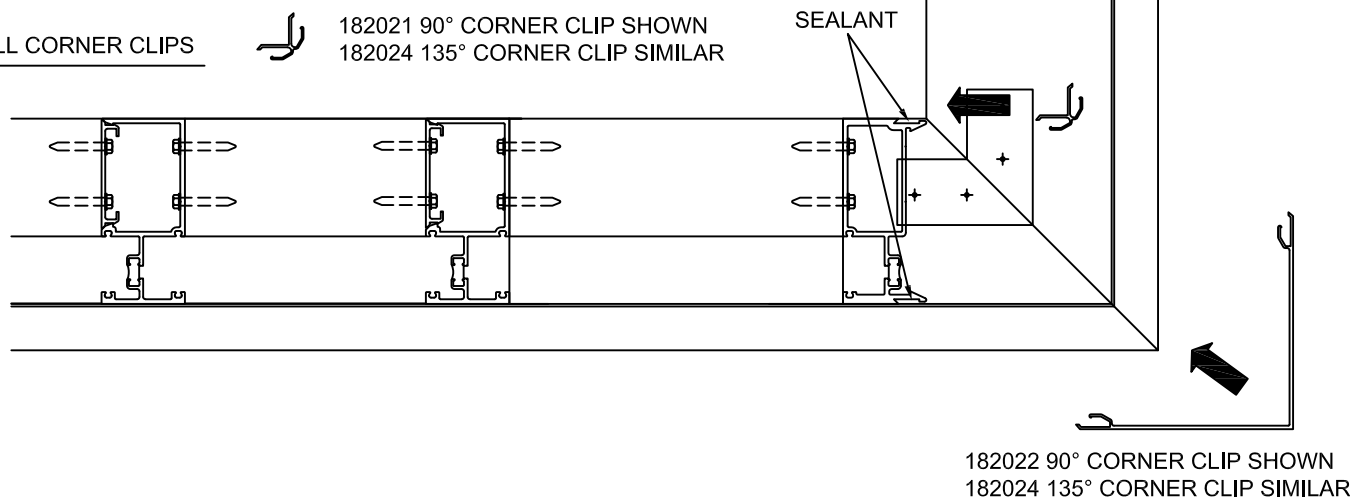

APPLY SEALANT 6" FROM END OF EXPANSION MULLION AT SILL BEFORE INSTALLING SECOND CORNER UNIT TO CORNER CLIPS. TOOL EXCESS AND CLEAN OFF SEALANT AT VISION AREA.

#### INSTALL SECOND CORNER UNIT

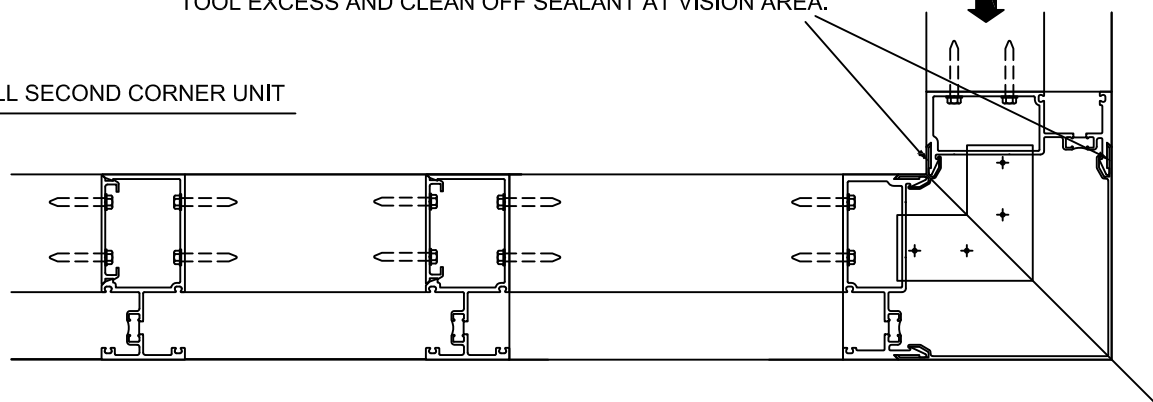

NOTE: 90° OUTSIDE CORNER SHOWN, OTHER CORNERS ARE SIMILAR

### INSTALL CORNER SLAB EDGE COVER

MITER END OF EACH SLAB EDGE COVER PER APPROVED SHOP DRAWINGS

CLEAN ENDS OF SLAB EDGE COVER ACCORDING TO SEALANT MANUFACTURER'S RECOMMENDATIONS. APPLY DOUBLE SIDES ADHESIVE TAPE TO BACK OF CORNER CLIP AND ATTACH THE CORNER CLIP TO SLAB EDGE COVER BETWEEN SLAB EDGE COVER SCREW SPLINE.

INSTALL SLAB EDGE COVERS INTO HEAD RECEPTORS AT CORNER LOCATION WITH MINIMUM 1/2" SPLICE JOINT. APPLY BACKER ROD AND SEALANT TO THE CORNER JOINT AS SHOWN.

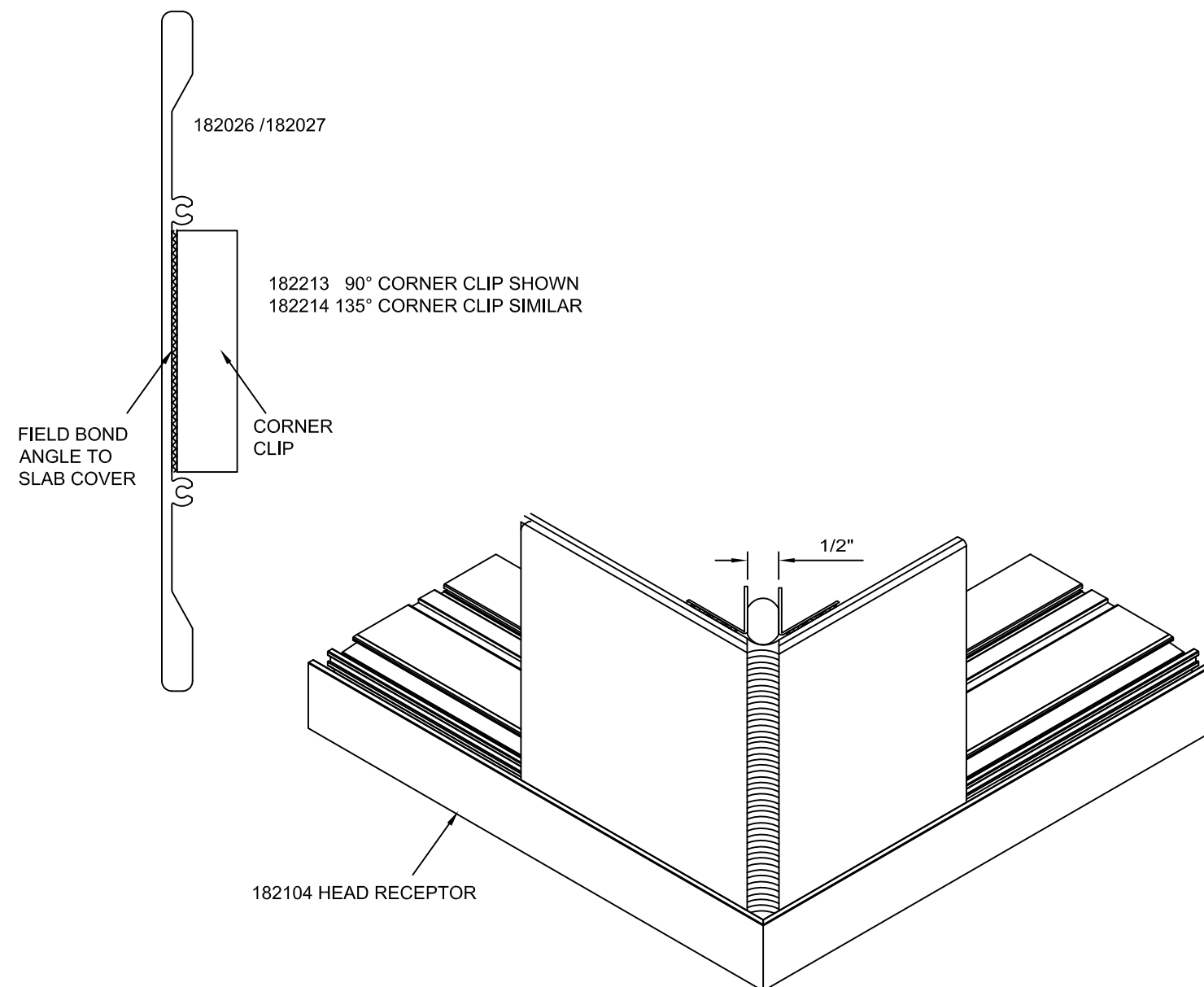

NOTE: 90° OUTSIDE CORNER SHOWN, OTHER CORNERS ARE SIMILAR



Product Engineering & Development

95527-004  
12/26/14

FG 501T CORNER  
INSTALLATION  
INSTRUCTIONS

182972 SHEET 04 OF 04